

GEBERIT PREFAB SOLUTIONS

THE COMPLETE BATHROOM PACKAGE

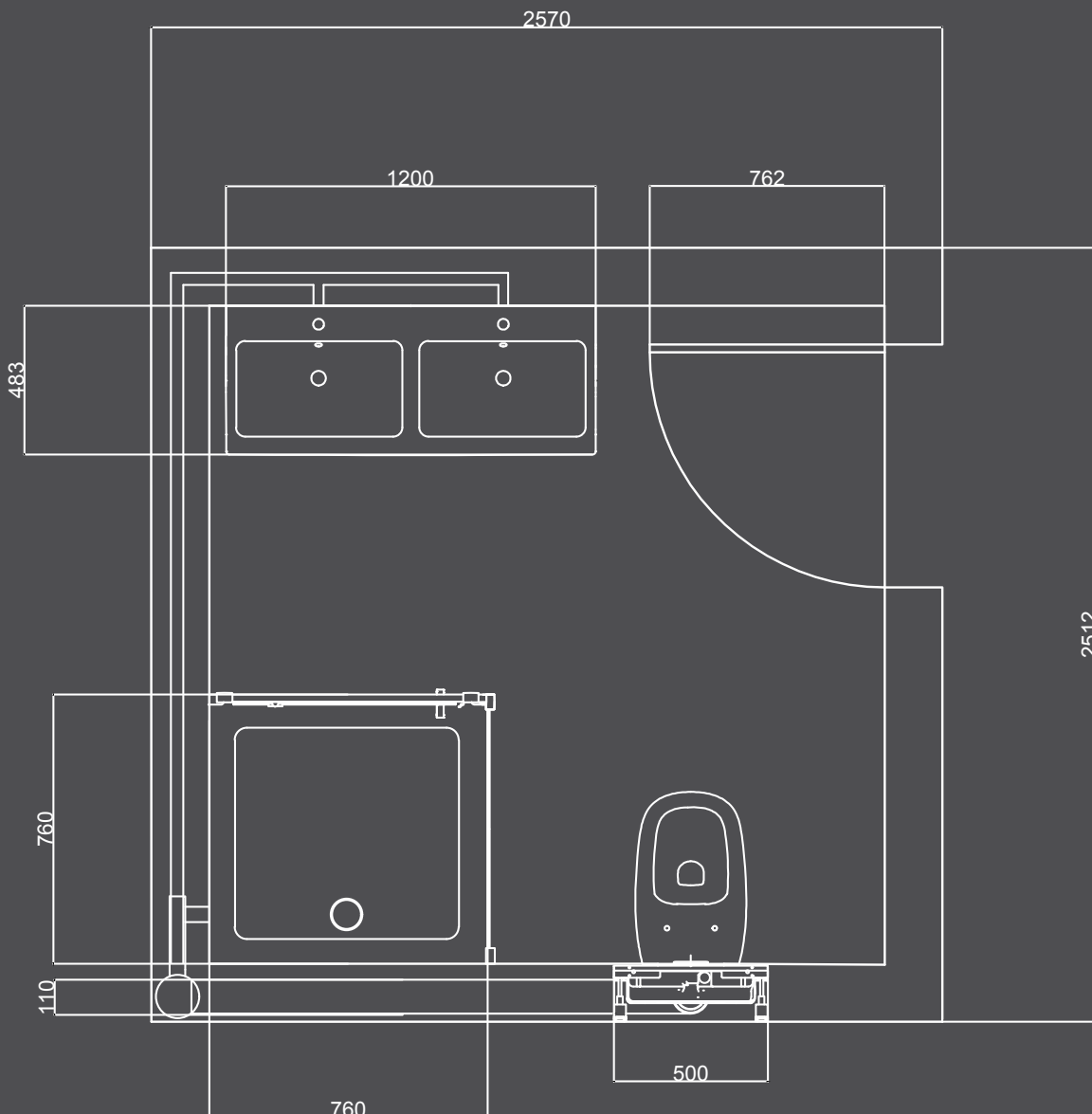

**KNOW
HOW
INSTALLED**

WE TICK ALL THE BOXES

✔ BRAND ✔ PRICE ✔ PRODUCT RANGE ✔ LOGISTICS ✔ SUPPORT



KNOW-HOW

We bring almost 150 years of Know-How to every new washroom and piping project, with every feature carefully crafted and designed to optimise user experience. Working across an extensive range of sectors; from hospitality to residential to education, you can be confident that we have the right Know-How to support your business.



INNOVATION

From unrivalled and inspirational ceramics to innovative drainage and supply piping to reliable concealed cisterns and installation frames; we offer the full washroom package for your project, both behind and in front of the wall. Our wide range of product solutions allow us to meet a range of project requirements at different price segments – all whilst meeting the local standards and regulations of product design and performance.



PARTNERSHIP

We work closely with you to add value to every prefabricated project. Rest assured, you'll be supported every step of the way. Your dedicated Key Account Manager with expert prefabrication knowledge will be on-hand to support your project – backed up with our UK based Technical team providing best in class aftersales, training, delivery and spare part availability services.



RELIABILITY

Our total focus on performance means our products combine safety and durability with ease of installation. Geberit provide quality products that are built to last – saving you time and money over the whole lifetime of the products.

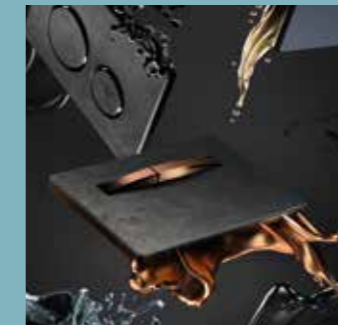

QUALITY OF LIFE

We set new standards in design, comfort and water management. From our innovative Rimfree® technology to low flush compatible WCs to stylish flush plates, we make life easier, more comfortable and more liveable. That is part of our long-term contribution to the environment and society at large.



CONTENTS

CASE STUDY	6
PRODUCTS FOR EVERY PROJECT	8
OUR COLLECTIONS	10
SHOWERING AND BATHS	12
POWERFUL TECHNOLOGY BEHIND THE WALL AND INFRONT	14
GEBERIT HDPE	16
ACOUSTIC CONSIDERATION	17
GEBERIT MEPLA MULTILAYER PIPE SYSTEM	18
SUSTAINABILITY AT GEBERIT	20
DEDICATED SUPPORT	22

CASE STUDY: MINAVIL HOUSE

AFFORDABLE MIXED-USE DEVELOPMENT

PROJECT OVERVIEW

The suburb of Alperton was designated a Housing Zone by the Mayor of London in 2015 and is a key regeneration area for Brent. Up to 6,000 new homes are planned for the area in north-west London.

Minavil House in Wembley is the gateway site to Alperton. A 27-storey mixed-use development, it comprises 251 residential units with 215 of these earmarked for shared ownership and the remaining 36 for affordable rent. Work started on the large-scale development in 2019 and is scheduled for completion in 2022.



BENEFITS OF BATHROOM PODS

OEP Building Services, a modular construction company based in Lancashire, worked with HG Construction and Clarion Housing Group to supply the bathroom pods across Minavil House.

Clarion Housing Group specified **Twyford ceramic sanitaryware**, with OEP then working with Geberit to develop the specification further. The fully fitted steel-framed bathroom pods were assembled at OEP's off-site manufacturing facility.

Max Rossell, purchasing manager at OEP, explains the benefits of specifying pods. "One of the main reasons why installing pod bathrooms is preferable for a project like this comes down to cost. Our manufacturing facility is based in the north of England which presents some serious price advantages over installing the bathrooms on-site in London. Just factoring in costs like the on-site parking for the teams of plumbers on a project of this scale has a huge impact on overall budgets. You also have significant economies of scale with the manufacture of hundreds of bathrooms off-site in one facility – less breakages, snagging issues and so on."

Prefabricated systems, where a variety of components are assembled off-site, is set to see huge growth here in the UK. In 2019, global management consultancy firm McKinsey & Co predicted that the UK could be one of the modular construction industry's principal markets for growth, with the pre-fabricated building market expected to grow by 8% between 2019-2025[^].

However, with the industry recognising the benefits of modern methods of construction, Max explains why it's not just cost alone that is driving the shift. "There is another huge advantage of quality control and consistency across a project. The factory-controlled conditions enable us to not only improve productivity, but also ensures that the ceramics are fitted to the highest quality standards. Every stage of the process is carefully managed and we quality test throughout the entire process."

[^]www.mckinsey.com/industries/capital-projects-and-infrastructure/our-insights/modular-construction-from-projects-to-products

CHOOSING GEBERIT

The range of products specified includes **Twyford E100 ceramics**, **Twyford Celtic steel baths** and **Geberit concealed cisterns**. Max worked directly with Geberit to determine the final bathroom specification. "We were impressed with the supply chain and availability of the products. The process was very straightforward indeed."

He adds: "We've worked with Geberit previously so both know and trust the products. We had first-class service, expert knowledge and support at every stage."



↑ First stage of construction.



↑ Pod is painted, tiled and fitted with electrics and plumbing.



↑ Pods are wrapped, ready for shipment.

PRODUCTS FOR EVERY PROJECT



From unrivalled and inspirational ceramics to innovative drainage and supply piping to reliable concealed cisterns and installation frames; we offer the full washroom package for your project – behind and in front of the wall.



HOTELS

Whether your hotel aesthetic focuses on design minimalism or maximum comfort, we provide a wide range of product solutions to meet the requirements of your project - from budget hotels to 5* establishments.

AFFORDABLE HOUSING

We understand that tenants' needs can be complex, our expertise covers all abilities, providing Doc.M packs for the less able, stainless steel baths and anti-vandal solutions. This unique level of understanding is the reason why today, we're trusted by social housing providers all over the UK.



STUDENT ACCOMODATION

Space-maximising and easy to clean – we offer a wide range of product solutions that support high footfall usage and easy maintenance, perfect for student accommodation ensuite bathrooms and communal washrooms.

PRIVATE RESIDENTIAL

From luxury homes and apartments to private rental developments - our expertise and product range cover a broad range of private residential project applications.

OUR COLLECTIONS

SPECIFY GEBERIT AND TWYFORD EVERY TIME – FOR COMPLETE COMPLIANCE AND TOTAL PEACE OF MIND. WITH OUR BROAD RANGE OF PRODUCTS, GEBERIT AND TWYFORD OFFER WASHROOM SOLUTIONS SUITABLE FOR A WIDE RANGE OF SECTOR APPLICATIONS; FROM EDUCATION TO PRIVATE RESIDENTIAL.

Twyford
Geberit Group



TWYFORD ALCONA

The Alcona bathroom range offers a versatile and classic design to suit all your project needs. This durable bathroom series features a comprehensive range of toilets to suit all applications including a dual flush close coupled toilet, fully back-to-wall and wall-hung - both compatible with Geberit Duofix Frames. Alcona now offers a choice of both round and square washbasins suiting any bathroom design. The entire Alcona toilet range features Twyford's water saving flushwise® as standard. Washbasins range from 350mm to 600mm and come with a full or semi pedestal.



TWYFORD SOLA

Twyford Sola is the flexible installation solution with back-to-wall or close coupled options which are economically sound and ecologically friendly. The revolutionary rimless toilet technology makes maintaining hygiene effortless- flushing effectively on 4 litres to meet BREEAM specifications. Twyford Sola basins have deeper side walls for superior strength and longevity. Enclosed fixings offer greater hygiene while our semi-recessed basins feature short projects, placing everything within easy reach.

■ GEBERIT



GEBERIT SELNOVA

With its classic lines, the Geberit Selnova bathroom series can be incorporated into any bathroom. Geberit has selected a simple and discreet design and brought the functionality to the fore. Geberit Selnova sets itself apart with its outstanding value for money and the uncompromisingly high quality that has become synonymous with Geberit. This affordable, yet functional range includes dual flush compatible solutions to meet the requirements of your project.



GEBERIT SELNOVA SQUARE

Geberit Selnova Square's modern, yet classic designs, blend harmoniously into any bathroom. This on-trend and affordable range of bathroom solutions offers Rimfree® for easier cleaning and maintenance as well as dual flush compatible WCs – fully tested with Geberit Duofix frames.



GEBERIT SELNOVA COMPACT

The Geberit Selnova Compact range offers ideal solutions for stylishly fitted out small washrooms, ensembles and guest toilets. Short projection toilets, handrinse basins with a short depth save those crucial few centimetres that make such a difference in a small room.



GEBERIT VARIFORM

Circular and rectangular, oval-shaped and elliptical: the design concept for the Geberit VariForm washbasins is based on the four most important basic geometric shapes and the three key installation variants – providing complete flexibility for your next washroom project.



GEBERIT SMYLE SQUARE

With its contemporary design and ornate lines, the Geberit Smyle Square bathroom series provides a premium design aesthetic for your washroom project. With a clear sense of order and efficient use of a room, Geberit Smyle Square achieves the highest level of convenience in the bathroom for any structural situation. Featuring clever design elements such as Rimfree® for easier cleaning and maintenance along with dual flush compatibility with Geberit Duofix frames.



GEBERIT ICON

Linear design, clear lines and yet so flexible – that is the Geberit iCon complete bathroom series in a nutshell. An extensive range of ceramic appliances and bathroom furniture in a modern design language provides the maximum in design flexibility and stands out due to its impressive versatility. The range includes short projection solutions for maximising smaller washroom space alongside clever design features such as Rimfree® for easier cleaning and maintenance along with dual flush compatibility with Geberit Duofix frames.

SHOWERING AND BATHS



GEBERIT GEO SHOWERING

The Geberit Geo Shower enclosure series provides a core range of framed shower enclosures which deliver clear space saving solutions with outstanding quality and design. With key features such as easy to maintain ProClean Glass coating and profile handles – the Geo series is the perfect solution for your next prefabricated washroom project.

GEBERIT SHOWER DRAINAGE

Geberit offer a broad range of shower drainage solutions to meet the requirements of your project. Geberit shower drainage solutions are characterised by attractive design, easy cleaning and hydraulically optimised outlet technology. Choose from CleanLine shower channels, in-wall drain or even floor drains for a compact option.

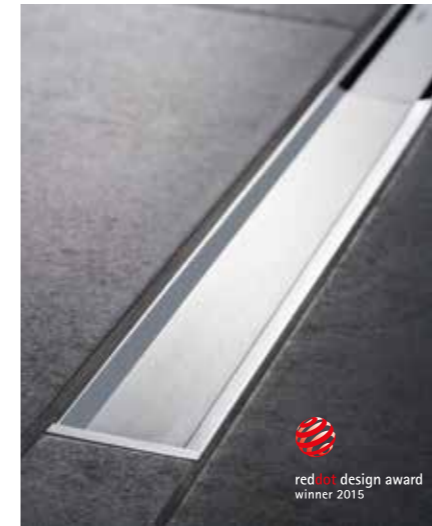

↑ Geberit CleanLine



↑ Geberit In-wall drain



↑ Geberit Floor-drain



↑ Twyford Celtic bath



↑ Twyford Aspect bath

GEBERIT AND TWYFORD BATHS

Choose from a range of shapes, sizes and design aesthetics to meet the requirements of your next project. From the elegant rectangular shape of the Twyford Aspect bath series to the durable Twyford Celtic bath range with added grips and slip resistant feature.

POWERFUL TECHNOLOGY BEHIND THE WALL AND INFRONT

The flush technology from Geberit - European number one in the field of sanitary technology - stands for sustainable reliability and the conservation of resources. Geberit flush technology saves water through low flush volumes and offers high reliability with a guaranteed spare parts availability of 25 years. Geberit cisterns are equipped for installation with the required electrical connections. This means shower toilets, odour extraction units, orientation light, touchless actuator plates and other devices can be installed or retro-fitted quickly and easily. With a large selection of ceramics, you'll find the perfect solution in front of the wall to create the dream bathroom.







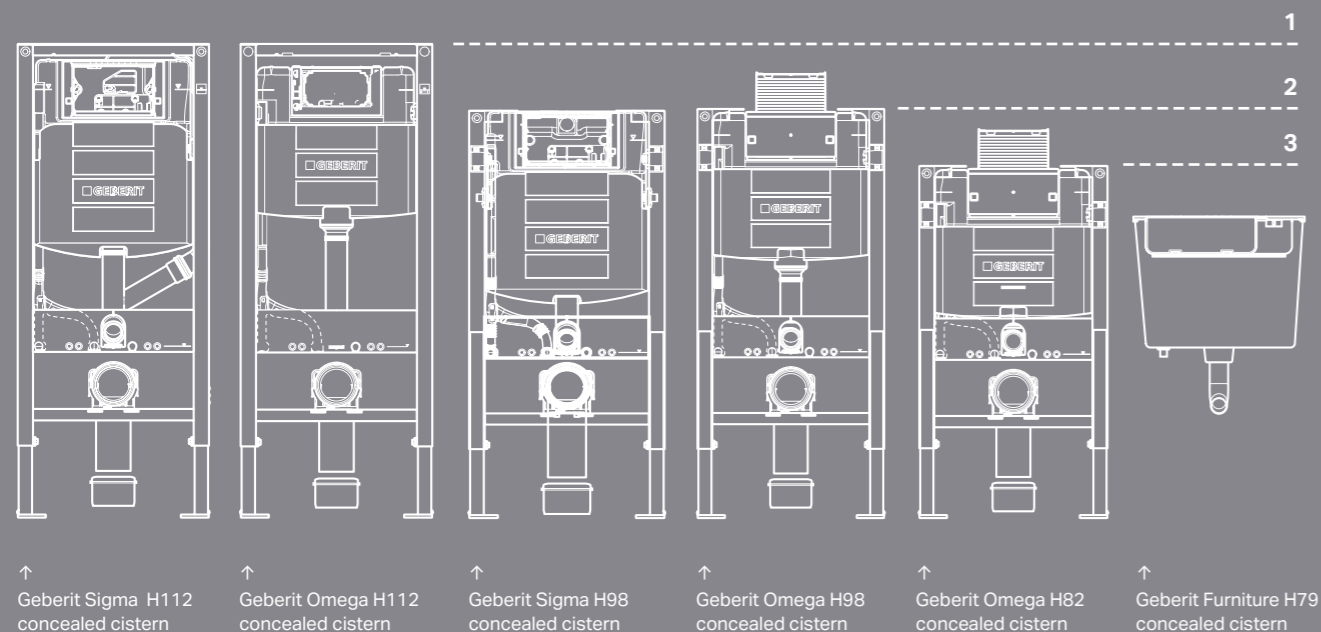



FURNITURE CISTERNS

At Geberit we are continuously developing our products to ensure we're always up to date with the latest innovations. Our new furniture cisterns have the ability to reach the low flushing volume of 4/2.6 litre.

GEBERIT CONCEALED FLUSH TECHNOLOGY



1 Construction height 112cm 2 Construction height 98cm 3 Construction height 82cm

-  Number one in the field of sanitary technology in Europe
-  Over 50 years experience with concealed cisterns
-  Installed more than 60 million times
-  At least 25 years guaranteed spare parts availability
-  Water saving
-  Load-bearing capacity of 400kg
-  Wide range of designs, functions and installation options
-  Odour extraction compatibility
-  Prepared for electrical connection
-  Height-adjustable at installation



Functions may vary by product model

GEBERIT FLUSH PLATES AND BUTTONS

Geberit's range of flush plates and buttons cover a wide range of applications to meet the demands of your project. From touch-free infrared flushes to dual flushes to anti-theft and tamper-proof solutions - choose from over 200 flushes.



Geberit Sigma50



Geberit Sigma60



Geberit Sigma10



Geberit Sigma30



Geberit remote flush button Type01



Geberit remote flush button Type01 Single flush

GEBERIT HDPE

AN ALL-ROUNDER **BEYOND COMPARISON**

THE GEBERIT HDPE WASTE AND DRAINAGE SYSTEM LEAVES LITTLE TO BE DESIRED: THE ROBUST PIPES ARE AVAILABLE IN ALL COMMON DIAMETERS, FROM 32MM TO 315MM, AND THE RANGE OF FITTINGS AND SPECIAL FITTINGS IS COMPREHENSIVE.

The polyethylene piping material is very light-weight, yet incredibly tough, and the connection technologies ensure permanent tightness and a high tensile strength. The system includes thoroughly tested components for effective fire protection and sound insulation as well as practical tools for the building site and the workshop.

- LARGE RANGE OF PRODUCTS WITH A WIDE RANGE OF DIMENSIONS
- HIGH TEMPERATURE AND CHEMICAL RESISTANCE
- FLEXIBLE AND IMPACT RESISTANT
- VARIOUS JOINTING OPTIONS
- ENVIRONMENTALLY FRIENDLY PLASTIC

**KNOW
HOW
INSTALLED**

THE IMPORTANCE OF EMBEDDING ACOUSTIC CONSIDERATION INTO WASHROOM DESIGN

Often wastewater noise is neglected when planning a high rise residential accommodation and the adjoining spaces. At Geberit, we have operated a sanitary sound laboratory from our head office in Switzerland since 1997. Unique to the industry, this facility allows Geberit to fully system test supply, sanitary ware and drainage and make informed recommendations for embedding acoustic considerations into washroom design. From acoustically-optimised pipework to decoupled pre-wall installation systems. Geberit offers a whole host of solutions to create a quieter, wellness enhanced bathroom environment for your residential project.

→ Find out more Geberit's Sound Solution white paper report at www.geberit.co.uk/acoustics

- 28% OF PEOPLE SAY THEY ARE REGULARLY AFFECTED BY WASHROOM SOUNDS INCLUDING THE TOILET FLUSHING, DRAINAGE AND PIPES*
- 30% HAVE BEEN DISTURBED BY WASHROOM NOISE IN A HOTEL IN THE LAST 18 MONTHS*

*Source: YouGov Poll commissioned by Geberit, (2054 respondents, January 2020)

FLEXIBLE AND INHERENTLY STABLE WITHOUT SOLDERING

- Flexible, bendable and yet inherently stable
- Clean, safe, easy to process
- Reliable press connection
- Quick and secure adapters to other systems such as Geberit Mapress
- 97% recyclable when separated into aluminium and plastic

The Geberit Mepla multilayer pipe system combines the advantages of metal and plastic.

This easy, reliable processing and a comprehensive range of pipe dimensions and fittings make Geberit Mepla a flexible, economical piping system. Geberit Mepla complies with all the necessary standards and regulations making it suitable for all relevant industrial and commercial applications.

Geberit Mepla is more corrosion-resistant and lighter than metal pipes and is more inherently stable and durable than plastic pipes. It can therefore be bent and processed easily and safely.



↑
PIPES AND FITTINGS FOR A WIDE RANGE
OF APPLICATIONS



↑
MEPLA SYSTEM PIPES UP TO 20MM CAN BE BENT BY HAND
WITHOUT DIFFICULTY

THREE LAYERS FOR DRINKING WATER AND HEATING

More corrosion-resistant and lighter than metal pipes, more inherently stable and robust than plastic pipes – easy and safe to process, Geberit Mepla combines the advantages of both types of pipe. Stable, bendable and able to form a barrier against diffusion, Geberit Mepla also remains leakproof when subjected to pressure far in excess of the maximum standard testing pressure of 1.1 MPa (11 bar). The outer plastic layer made of polyethylene (PE-RT of the second generation) protects against corrosion and mechanical damage. The central aluminium layer makes the pipe stable and bendable. The inner layer, which is likewise made of PE-RT, is corrosion resistant and food-safe. Geberit Mepla can therefore be used for all drinking water qualities without analysis.



SUSTAINABILITY AT GEBERIT

CARE IN THE SQUARE

Geberit creates a sustainable quality of life with innovative water management, comprehensive Know-How and a strong focus on sustainability – across all products, sectors and processes.

It's an approach that really pays off for the environment and society, as well as customers, partners and employees. Our examples include products for green buildings – a market of the future – ethically aware training, outstanding logistics and every drop of water saved by Geberit products worldwide, that's what 'Care in the square' means to us.

LEADING THE WAY IN GREEN LOGISTICS

In logistics, we have been attaching equal importance to both ecology and efficiency for many years. The logistics centre in Pfullendorf (DE) therefore sets the standard when it comes to green logistics.

From implementing automated works steps to embracing progressive technology, Geberit is focussed on supporting employees to carry out their work efficiently, safely and in an ergonomic manner. In addition, logistics partners are selected according to a clearly defined quality criteria and are contractually obligated as our preferred shippers to use energy efficiently – working together to reduce CO2 emissions.

WATER SAVING SOLUTIONS

Efficient use of water and reducing water usage continue to be high on the agenda many projects including residential buildings. At Geberit, we offer a wide range of sustainable solutions to support environmental assessment certification systems such as BREEAM and LEED – helping you to achieve great results for planet and your pocket.

EFFECTIVE DUAL FLUSH FOR DOMESTIC

Our low litre flush cisterns are fully system tested with our WC pans to ensure compatibility even at low flush volumes. In line with the latest EN997 class 2 testing. This range of low litre flush solutions can contribute to achieving maximum BREEAM points for new domestic and commercial buildings. Our team of dedicated Specification Sales Managers are on hand to support you with achieving maximum performance levels using effective flush volume calculations.

→ View our full range of frames and cisterns at www.geberit.co.uk/duofix

BREEAM®





DEDICATED SUPPORT

DEDICATED TEAM

From planning to logistics to stock availability and aftersales, we're exceeding expectations to offer you a wide range of products to suit any development. At Geberit, we have a dedicated team in place to support your housing project from start to finish.

TRAINING

Geberit provide a free, comprehensive CIPHE accredited training day. This can be provided for all installers including sub contractors and apprentices. With a choice of visiting the Warwick Training Academy or delivery of the training on site, the program offers flexibility to suit your needs.

- Free training day including lunch
- Training certification
- Onsite or head office training sessions (depending on the size of the project)



Geberit Sales Ltd
Geberit House
Edgehill Drive
Warwick
CV34 6NH

T 01926 516800
F 01926 400101
E specification.gb@geberit.com

Literature 0800 007 5133

→ www.geberit.co.uk
→ www.twyfordbathrooms.com